[illegible]

F9GI AC 89 5UC				
5uC	6-H	7CADF	D9GC	
	aa	a		_Iz
\$5	..)	%		(.
\$5	..)	() %		%&
\$5	..)			(.
\$5	..%	(&
\$5	..%&	%&		%&
\$5	..%	%&		%&
\$5	..&	% (+		&
DYgc HchU		* % 1		(- Z
DYgc HchU		% 1		- + Z

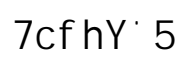
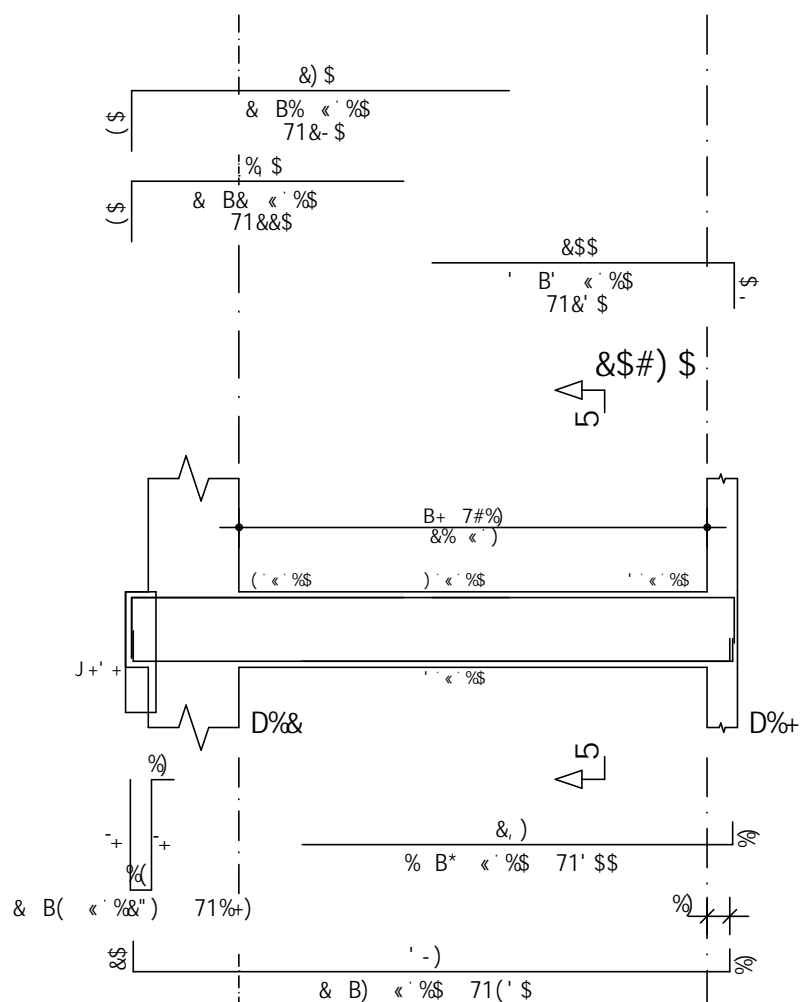
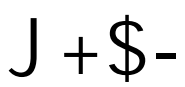
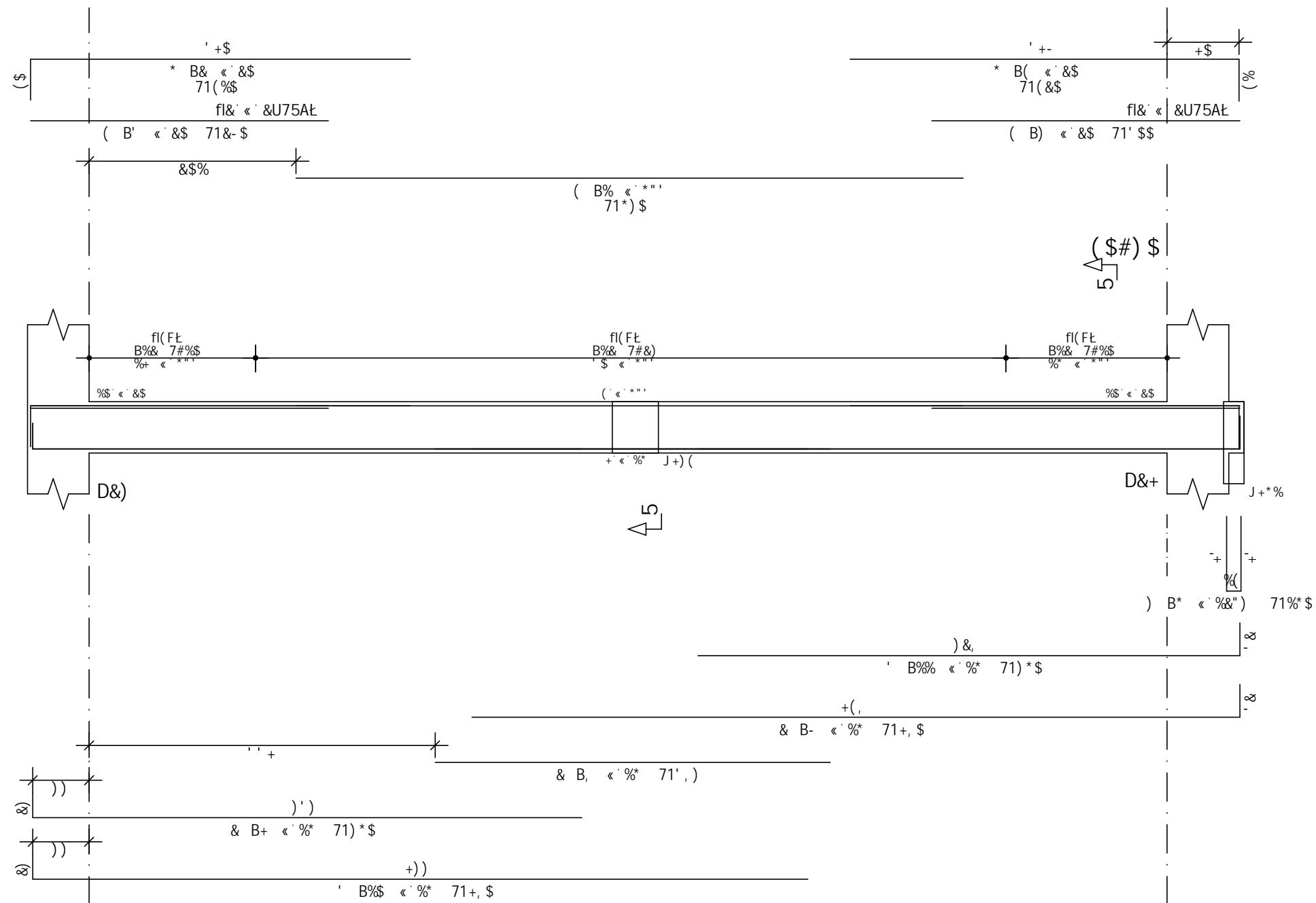
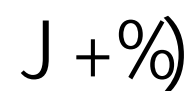

BCH5G

36 A:9B9G0G 9A 79BH-A9HF0G 989J5U69G 9A A9HF0G
 87 7CB7F9H 9GHE HF58
 * VJ21 8S ADU RHG5765 H4D H5-NC 1E S5: 5A6G5G5
 1E 989G0G 989G0G 21 \$S5J.5# / F9U6U5C 97 9BHF9 S2) 9 S2/
 5 F9 5BC 1 S5F-5
 5:19 S2 ADU RH8A5 S C 989A9BHG 9GHE HF5-GL 7CBG3 AC 89 7-A9BH
 7CBG3 AC 89 7-A9BH C 21 \$S2J.5#
 * 7HCF A: 15F7-A9BH C AAL-AC S2 S
 5:689 AC 5 F9G0J-BS89 == 1E 165B5
 (* A6G0 AC 9895G47-BS89 -B:7-5S 5- 8-5G -1:5# 5 * S+ ADU
 * F9S@N5F CG DF79B-A9BHCG 89 7JF52 F9H-F585 89 :CFA5G 89
 967CF9A8G 7CB CF9 BAF 96 * 83S / 9A9CF-5 A9BHCF-HJJC
 DF7989F 7CA 5 JF151 A-85 DCF BC A3B-AC +H9M 9G9L 8HC
 1H-@N5F 5 JF151 F5A-85 DCF 99A9BHCG 89 7CB7F9H
 5 9 9J7H U6E 85 9GHE HF5 89JF9A 7CBH5F 7CA C 57CAD58-989G 89 IA
 A97B8C @-GH5 89 7CB7F9H
 C 9 B9 964 C F9GDC8G9J 9JH D9H5 C6F5 89J9AC F9C69979G 5G
 F9B9895U69G 85S BCFASG 7H6-7B5 5G5 7A1F9C 89 79G-758BC 9G097-5H
 5H9BUE CG 89 J-1H89F5J-BS89G
 * 85 7CB7F9H 9F 9D505C 7CBHCF-9F 9799-A9BH C HF5B3D9H5F9H
 85B9A9BHC42 5898G9A9G 9J 7JF5
 (* CFA5 7CB 97A87-5 85C A9B8-85G 9 DCG-u69G 9G
 9G89F9-BS89G 55H15F5U6E 85G : A5A9CF567 989H F9H-F585
 9L79GCG 89 A 7JF17-7B5G 7CA C 1G 8G 89GAC 589G65B8HG
 9 F9H-F585 85G :AC45
 * F5A5UE C @-AD9N5G AC5 95AC 7CBF-A9BH C 89 89 9GDSU58C9F
 DMH-GH70C 989JH 58G0J.2 9 : F5H8-5 85 DCG-u6E 85G F5A5H 5F
 589G 9 8J F5B8H 5 7CB7F9H 9A
 7CBF-A9BH A3B-AC 85 F5A5H 5F
 55-9G182 SVWJ : J-5 G : D-85F9G12J VJ6 /687CGJ 2J\$TA/ 9G-H575GJ 2J\$W/
 C6F5 7CA 89 C- 7CB7F9H 989J 9E1 5H-BS89
 589G F97CA9B8H 9J 9J CG A5HF-5+5 95U C 7CB7F9H C2 1H-@N5B8G
 89G9H DF-C9HF 989S 9A 6A9H-8CG 5 98G5-8CG H97B8C : 7CG
 BOCYF 9F 85J 989A 9A 9HJ @-AD9F A9B8-@N5U6C D5F5 5 7CFH-B8G
 C7CBH9HUE9G
 7CB 9C 9F 9F A9B8-B8C @C75H*

9L9	\$&	F9J=GE< J=; 5' J+=%	9.-7&7=5	' \$F\$' #&#
9L9	\$%	5J5&=5uE< 89' 7C< CFA=8589	9.-7&7=5	% #&#&#&#
9L9	\$S	DfC>9HC 9L971 H=J< @=7+5uE< C6F5	9.-7&7=5	' %\$' #&#&#
F9J7CAD	\$&	F9J=GE< DfC>9HC 9L971 H=J< F9. 9L9 &	9.-7&7=5	& (#\$) #&#&#
F9J7CAD	\$%	F9J=GE< DfC>9HC 9L971 H=J< F9. 9L9	9.-7&7=5	\$' \$' #&#&#
F9J7CAD	\$S	9A=GGE< =B=7=5@ 9L971 H=J<	9.-7&7=5	& (#\$) (#&#)
5BH	\$%	F9J=GE< 5BH9DFC>9HC	9.-7&7=5	&#&#&#&#&#
5BH	\$S	9A=GGE< =B=7=5@ 5BH9DFC>9HC	9.-7&7=5	% #&#&#&#&#
H=DC	F9J	89G7F=UE<	89G9B<C	8SH5

F9J=GE9G	
A=B=GH/V=C: DI 6@=7C: 8C: 9GH58C: 89 A=B5G: 9F5=G G989 85G: DFCACHCF=5G: 89 >I GH=u5: 89' >I =N' 89': CF5	
9B899f9C.	af95' 9H9F9BC.
F I 5 >CgV 75@=@ 5c I 5; =2' @CH9: 2' 65=L585: 8C: D5F5=6I B5	8' - - '2' Sa&
	af95: 7CBGHFI 485.
DFCDF=9H4F=C.	*' &* '2' 'a&
	7BD>.
	&\$%' - - %\$) +\$\$\$\$% ()
DFC7I F58CF=5: 9F5@=89' >I GH=u5: 8C: 9GH58C: 89 A=B5G: 9F5=G	

DFC>9HC' 89' 9GHFI HI F5' 89' 7CB7F9HC' 5FA58C	
9ADF9G5.	7BD>.
9B' 9B<9-FC' : á6=C' >CGV' A57=9@ 89' C@=J9=F5 7F95 ' %@%' %&8I A' 9: =7á7=5 DFC>9HCG' 9' 7CBGI @HCF=5 @H85	\$\$\$' \$%' %@' \$\$\$\$ \$ \$
F9GDCBGáJ9@ Hv7B=7C.	7F95.
B9@GCB 1F=5G D=BHC' ; 5F=: @=C 85' G=@5	, &' * & (#8I A;
7CBH9I 8C. 5FA5uE' 89' J=: 5G' I' +c' D5J=A9BHC' ! ' \$&#\$.	85H5. ' '\$#\$' #&#' : C@<5. 9G75@5, =B8=7585 , (#/%*